



Vantage Systems Racking Selection Guide

Weight restrictions

Each Shelf can hold 40kg evenly distributed

Each drawer can hold 20kg evenly distributed

Assembly Instructions

Please follow these instructions carefully. Failure to do so may cause injury, or your product to function incorrectly.

Before drilling the floors place the racking into the desired position and ensure that the doors close and the rear door hinges are not obstructed

Assembly tools required – 5mm Allen key, 13mm spanner, tape measure and rubber mallet.

Step 1 - Shelf and top tray assembly

Fig 1 - Peel away protective strip from double sided tape (if fitted).

Fig 2 - Attach shelf ends (A) to shelf body (C) with taped flange (B) on the underside of shelf and side tabs on the insides of the shelf. Shelf ends with 4 cage nuts attached are used on top shelf with equally high lips.

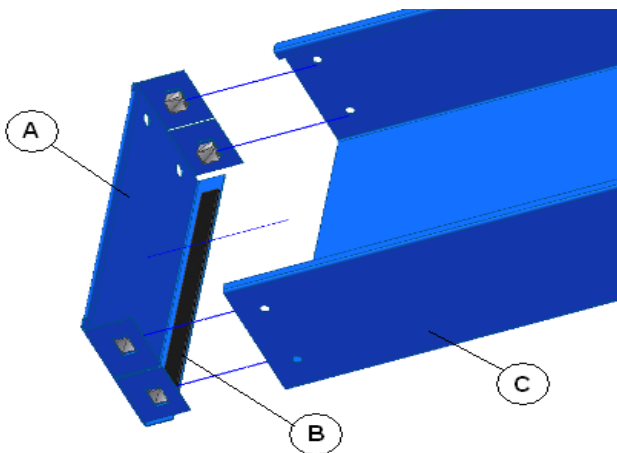

Fig 1

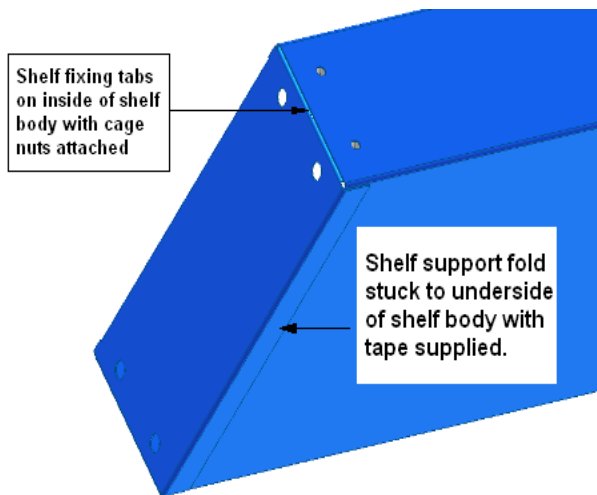
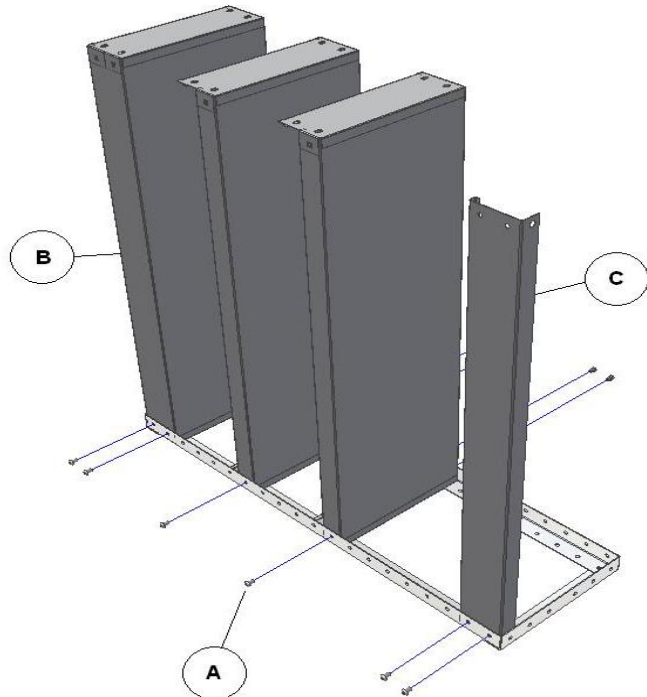

Fig 2

Step 2 - Main assembly part 1



Place end frame on a protected work surface. Place shelves into open face of end frame at desired positions. (Top shelf (B) with equal height lips must be positioned at top of unit to form stability). Attach top shelf and shelves using M8 dome head screws (A) through end frame into cage nuts in shelf ends. Use rubber mallet to move shelves into exact position to align holes.

Tip – Leave all screws hand tight until unit is fully assembled.

Attach kick plate (C) using M8 screws and M8 nyloc nuts. Position at the front of the unit at the bottom. Large flange down.

Step 3 - Main assembly part 2

Place end frame onto partly assembled unit. Use rubber mallet to align holes. Attach end frame to shelves and kick plate using M8 dome head screws as before. Check the unit is square before tightening all screws. Do this by measuring from corner to corner in each direction (If unit is square, both measurements will be the same). Finally, secure an M8 screw and nyloc nut in the bare corners of the unit to add to its strength. (X) When all screws are tight the unit can be removed from the work surface (get help with this).

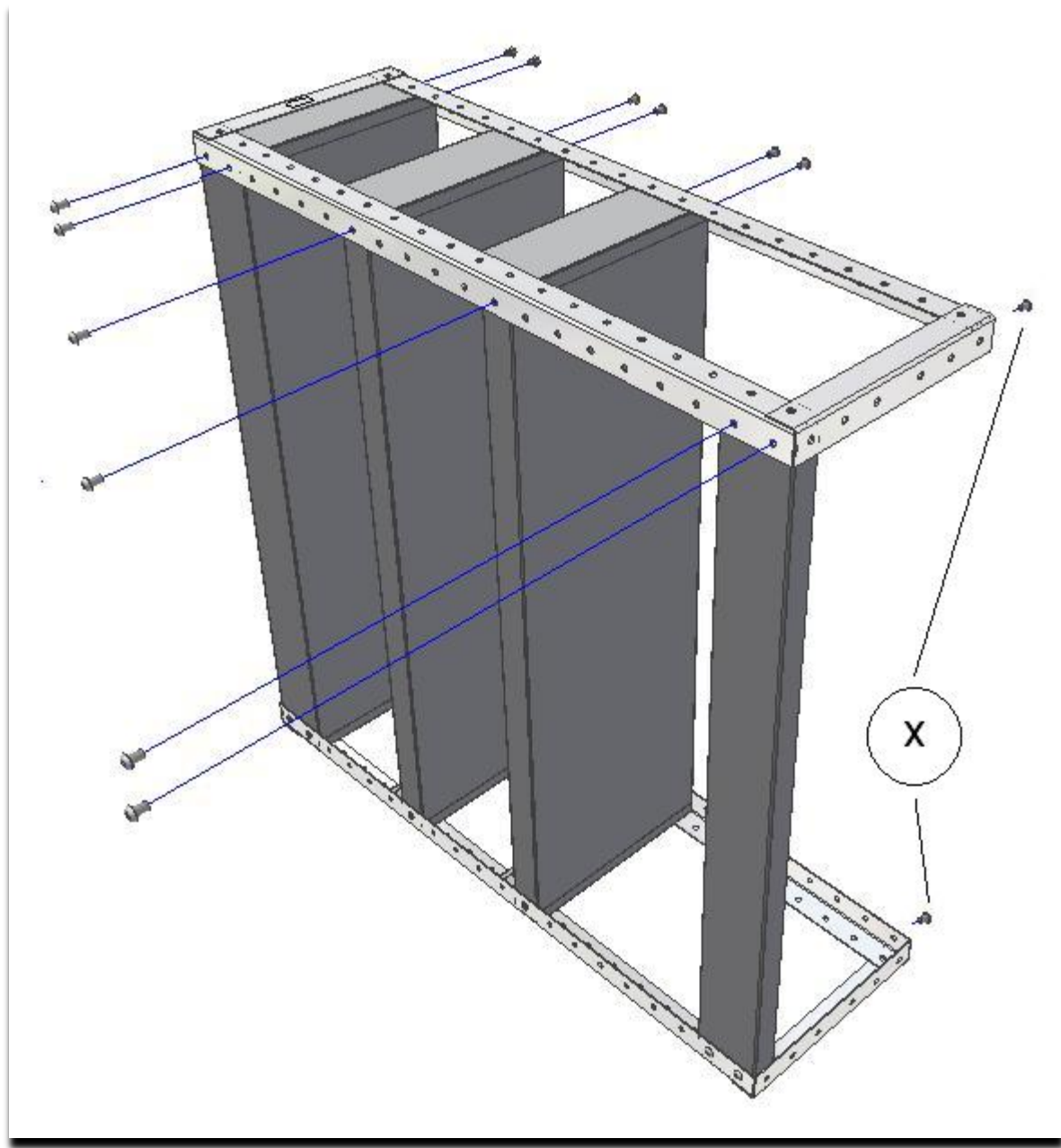

Congratulations. Your rack is now complete and ready to fit into your vehicle. The supplier is not responsible for the installation unless fitting has been arranged prior to sale. It is advised to check the assembly every 3 months to ensure all fixings remain secure. We hope you are happy with your purchase and will recommend the quality, value for money and ease of assembly to anyone with similar requirements.

*Please note that although manufactured to the highest quality, this unit has not been subjected to crash testing. Do not exceed 40kg per shelf (UDL).

Shelf Rack Installation Guidelines

Please follow these guidelines to ensure your rack is fixed securely in your vehicle. Failure to do so may cause injury or your product to function incorrectly.

Tools required – 13mm socket wrench, 13mm spanner, drill with 9mm steel bit, 8mm hex driver, tape measure and pencil. Help is required when bolting racks to vehicle floor. Wear safety goggles when working underneath vehicles.

Floor fixing method (fig 1.1) – Racks require a minimum of two bolts per endframe through the vehicle floor. We strongly recommend that the vehicle also has a plywood floor in good condition that is a minimum of 9mm thick. Position rack where desired and mark inside corners for reference if rack is moved. Measure from side and rear of vehicle to obtain position of endframes on vehicle floor. Using same measurements underneath vehicle to check that underside is clear of any obstructions so drilling and bolting can take place. Common obstructions are spare wheel, fuel tank, brake pipes and electrical cables. (It is possible to lower fuel tank and spare wheel if required).

With rack in position, mark hole centres with pencil. Move rack to one side and drill through floor of vehicle. Re position and bolt down using M8 x 50 bolt (B) with flat edged 30mm washer (A). Secure underneath with M8 nyloc nut (D) and 30mm plain washer (C). It may be necessary to drill through a floor support member (E). Take care when doing this as there may be cables inside. It is advised to coat visible bolt threads with under seal or grease.

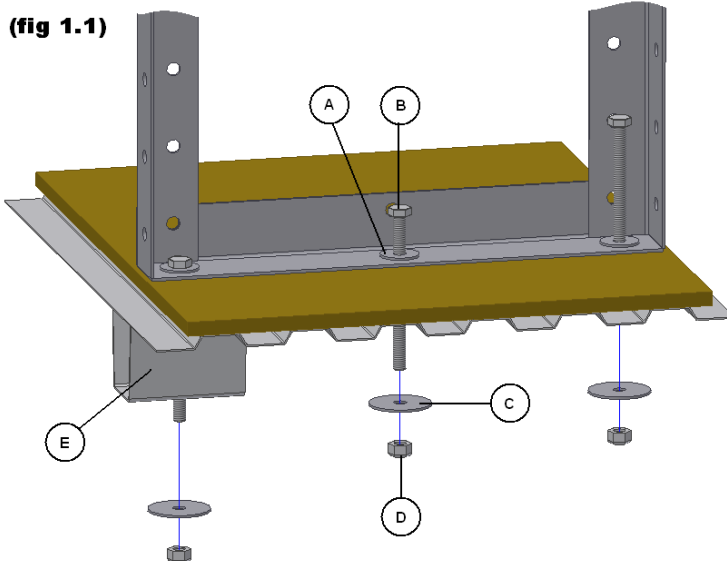

Side fixing method (fig 1.2) – Racks require a minimum of two side fixing points. Locate internal side supports in vehicle behind rack. These are usually used when attaching side lining. Fixing brackets will be screwed into these.

Bolt fixing brackets in required positions on rack using M8 dome head bolt (A) and nyloc nut (B). Brackets are supplied flat and need bending to desired length as distance between rack and vehicle side may vary. Fix bracket to side wall of van using self drilling screw (D) and 25mm washer (E). Take care not to damage or screw through outer skin of vehicle.

For mounting rack against bulkhead of vehicle use same procedure taking care not to screw through into upholstery. Please ensure all racking is secure before using the racking and moving the vehicle.

(fig 1.2)

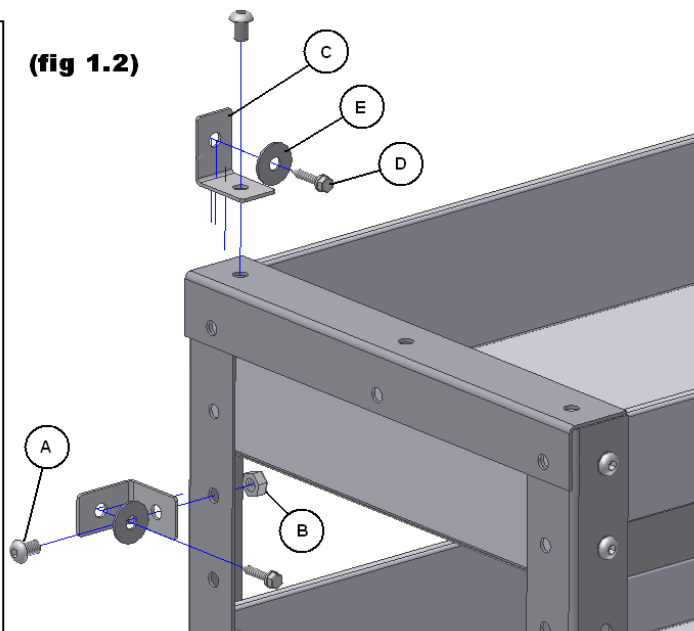

Please ensure PPE is worn and you are working in an area where it will not affect others to avoid any injury to you or others. Exercise caution if using power tools and only use as the power tool manufacturer recommends. If you do not own the vehicle please ensure the owner has agreed to the vehicle been modified. Ensure all the equipment is secure prior to moving the vehicle. It is important that the security of all fixings is checked periodically but we do recommend this is done every 2 months. Please exercise extreme caution when drilling the vehicle as Vantage Industries or any of its associated business's cannot be responsible for any damage or consequential damage. Please ensure the recommended fixing instructions are used.